

Mini-Steering-Wheel

For highest precision.

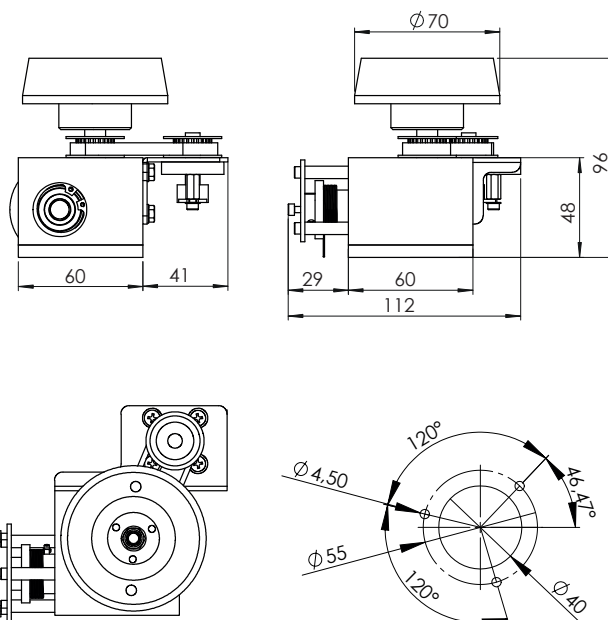
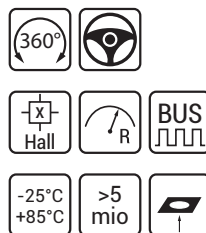

This extremely sensitive mini-steering wheel has a play-free metal mechanism, which ensures a long mechanical life. For very smooth and even more precise steering, it can also be made with oil damping. The turning movement can be carried out either on 3.5 rotations, 6.5 rotations or continuous without end stop. The play-free design ensures a 1:1 transmission of the steering movement. The analogue output signal is provided optionally by conductive plastic

potentiometers or non-contact Hall sensors. These are also available redundantly to comply with safety regulations. The mini-steering wheel can be combined with different electronic interfaces for integration into the customer's system. Different, also customer-specific steering attachments are possible as required. This steering wheel shows its strengths in applications that require reliable steering of fast vehicles and machines in the construction or agricultural industry.

Arrangement

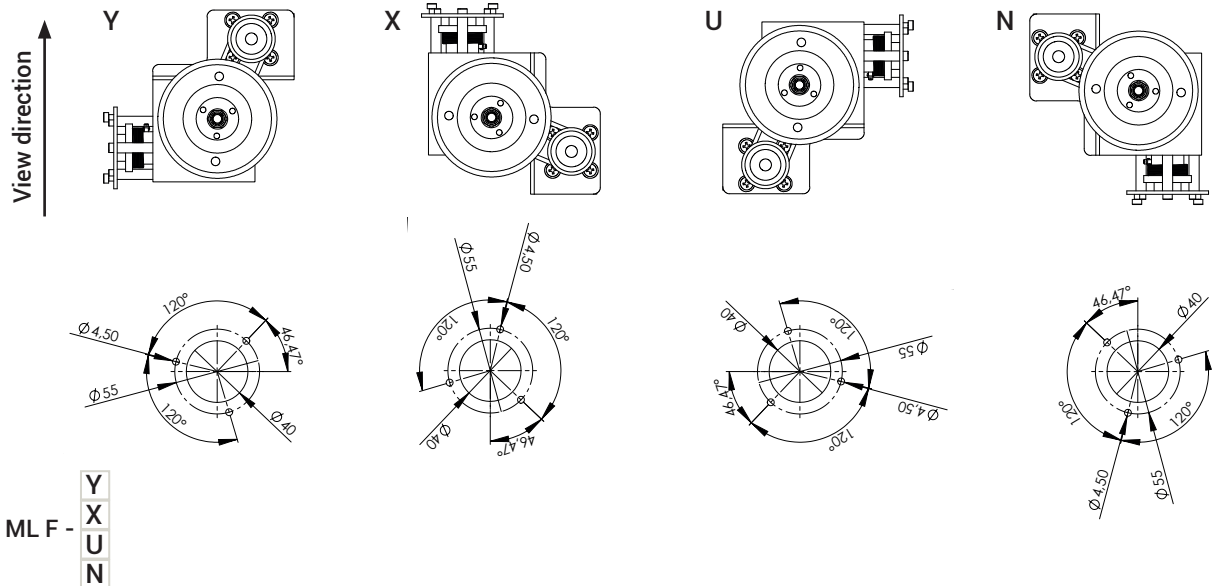

Scope of supply:

- Metal drive mechanism
- Steering attachment \varnothing 140 mm incl. rotating ball knob
- 3,5 rotations

More technical informations:

- mechanical TI-ML

- Potentiometer
- Hall-Sensors
- Rotation damper oil-filled 2 Ncm
- Rotation damper oil-filled 5 Ncm
- 6,5 rotations
- Without end stops (continuous)
- Other steering attachments
- Wiring to connection cable or plug

Type code:

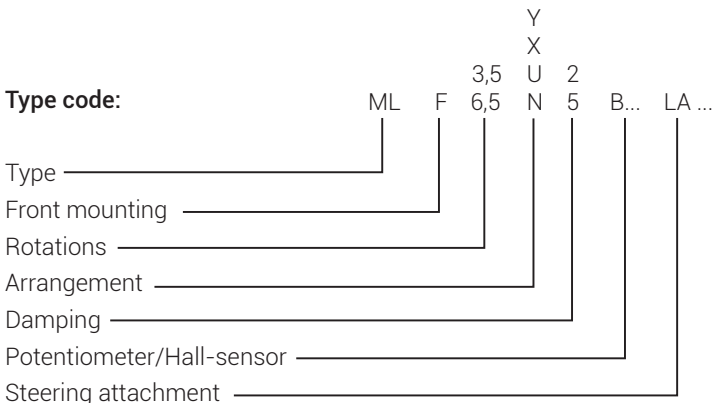

Dimensions, Installation from bottom

Mounting dimensions	ø 40 mm
Fastening bores	3 x 4,5 mm
Mounting depth	71 mm
Height with steering attachment	~ 70 mm
Further dimensions see TI-ML-2/2	

Mechanical characteristics

Rotations	3,5 / 6,5 / continuous (without end stop)
Damping	2 Ncm / 5 Ncm
Life cycle	> 5 million switching cycles

Electrical characteristics

Sensor type	Conductive plastic potentiometer Hall-sensor
-------------	---

General characteristics

Working temperature	-25°C to +85°C
Storage temperature	-40°C to +105°C

Version:

Front mounting

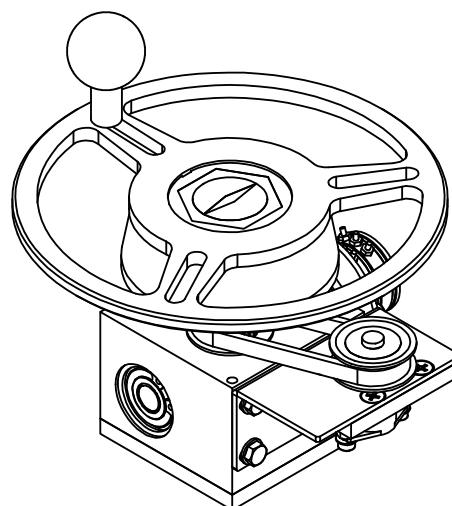
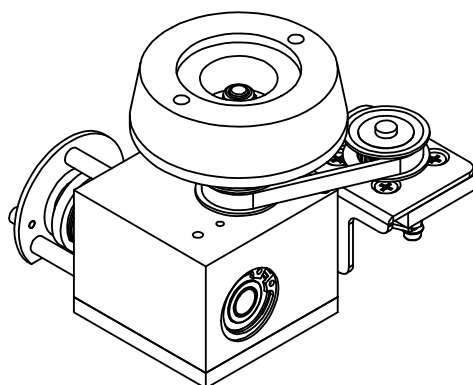
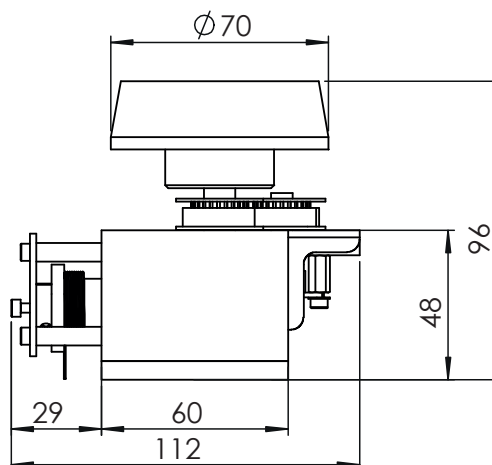
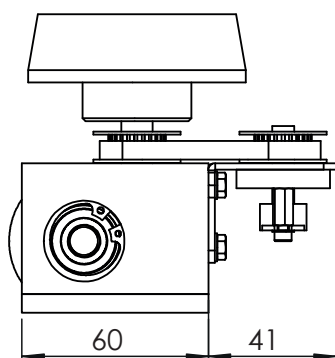

Picture: with steering attachment

View direction ↑

