

G2

T-handle with many installation options.

Example

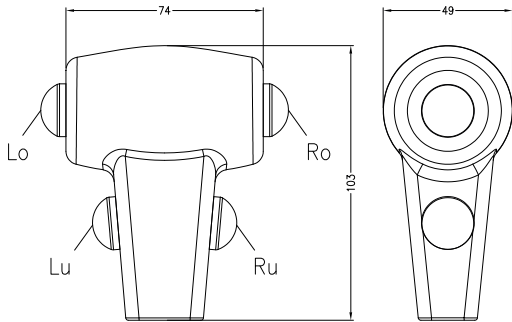

Version

Handle without inserts	G2-8 / G2-12	
------------------------	--------------	--

Options for handle G2

Pushbutton flat or high, 1NO, coloured cap, wired with single leads, 0.5 m long, AWG24	FS, HS	
Pushbutton flat or high, 1NO 1NC, coloured cap, wired with single leads, 0.5 m long, AWG24	FOS, HOS	
Protection cap for flat pushbuttons, transparent	RBF	
Protection cap for high pushbut- tons, transparent	RBH	
Capacitive hand detecting sensor	KT	see E-Elec- tronic-2

Type code:

	8				
	G2	12	LoHSBU	RoHSGN	LuFSYE
Type _____					
Adapter for Spobu-Joysticks with					
8 or 12 mm lever					
Inserts with position, type					
and colour information					

Cap colours:



Note:
• Notes on handle wiring and maximum number of cores, see sheet G-V.